

REVISIONS

QTY	MODEL USED ON	ASS'Y NO.	LTR	DESCRIPTION	DATE	E.M.N.NO	DRAFT	CHKD	APPD
1	TLAAIK	AX5132	Ø	ORIG. RELEASE FOR PROD	9/9/71		RG		
			A	ADD OBSOLETE NOTE	4/13/2007		GE	Ø	Ø

MARK TMC PART NUMBER
1/8 HIGH GOTHIC WITH LATEST
REVISION LETTER ON REAR OF PANEL

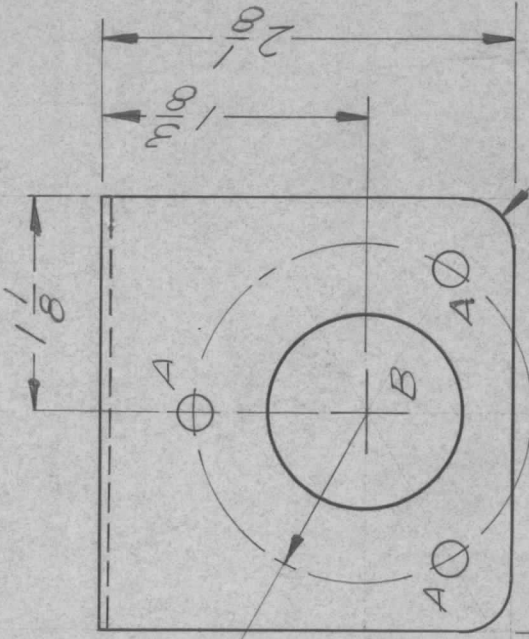
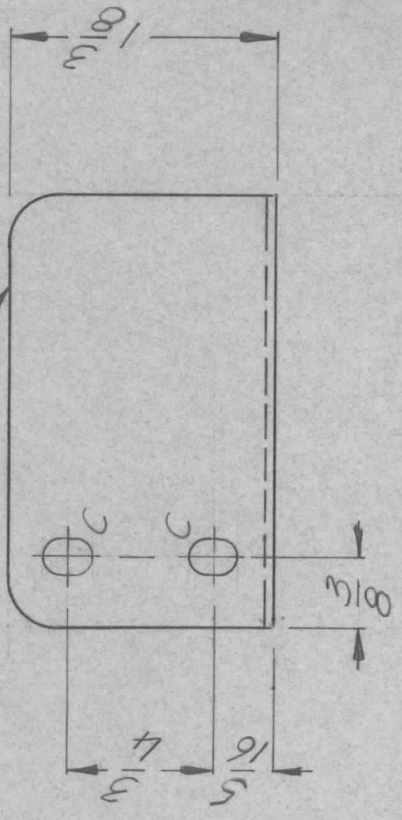

OBSOLETE
24
OBSOLETE 1/4 R TYP

SUPERSEDED
DIRECTLY REPLACED BY
MS 6384

3 HOLES $\frac{7}{8}$ R
120° APART

A — 11/64 DIA — 3 REQ.
B — 1" DIA. — 1 REQ.
C — 11/64 x 11/32 SLOT — 2 REQ.

UNLESS OTHERWISE SPECIFIED:

1. USE MATERIAL THICKNESS FOR MAXIMUM RADIUS ON ALL BENDS.
2. ALL ANGULAR BENDS 90 DEGREES.
3. REMOVE ALL BURRS AND SHARP EDGES.
4. MOUNT INSERTS AFTER FINISHING.

REQ'D	ITEM	PART NUMBER	DESCRIPTION	SYM.
	F. BUDETTI		LIST OF MATERIAL	
	FINAL APPROVAL		THE TECHNICAL MATERIEL CORP.	
	MECH. DES.		MAMARONECK, NEW YORK	
	ELECT. DES.		STRAP, CONTACT CAP	
	CHECKED			
	DRAWN			
	SILVER PLATE			

DATE	DATE	DATE	DATE	DATE
9/9/71	9/9/71			8/23/71

SIZE	CODE IDENT. NO.	DWG NO.	ISSUE
A	82679	MS 6242	A
SCALE	SHEET		OF
1:1			

NOTICE TO PERSONS RECEIVING THIS DRAWING
THE TECHNICAL MATERIEL CORPORATION claims proprietary right in the material disclosed hereon. This drawing is issued in confidence for engineering information only and may not be reproduced or used to manufacture anything shown hereon without permission from THE TECHNICAL MATERIEL CORPORATION to the user. This drawing is loaned for mutual assistance and is subject to recall at any time.