

ZONE	LTR	DESCRIPTION	DATE	INITIALS
	X	EXP RELEASE	12/5/69	
	Ø	ORIGINAL RELEASE	1/4/70	u

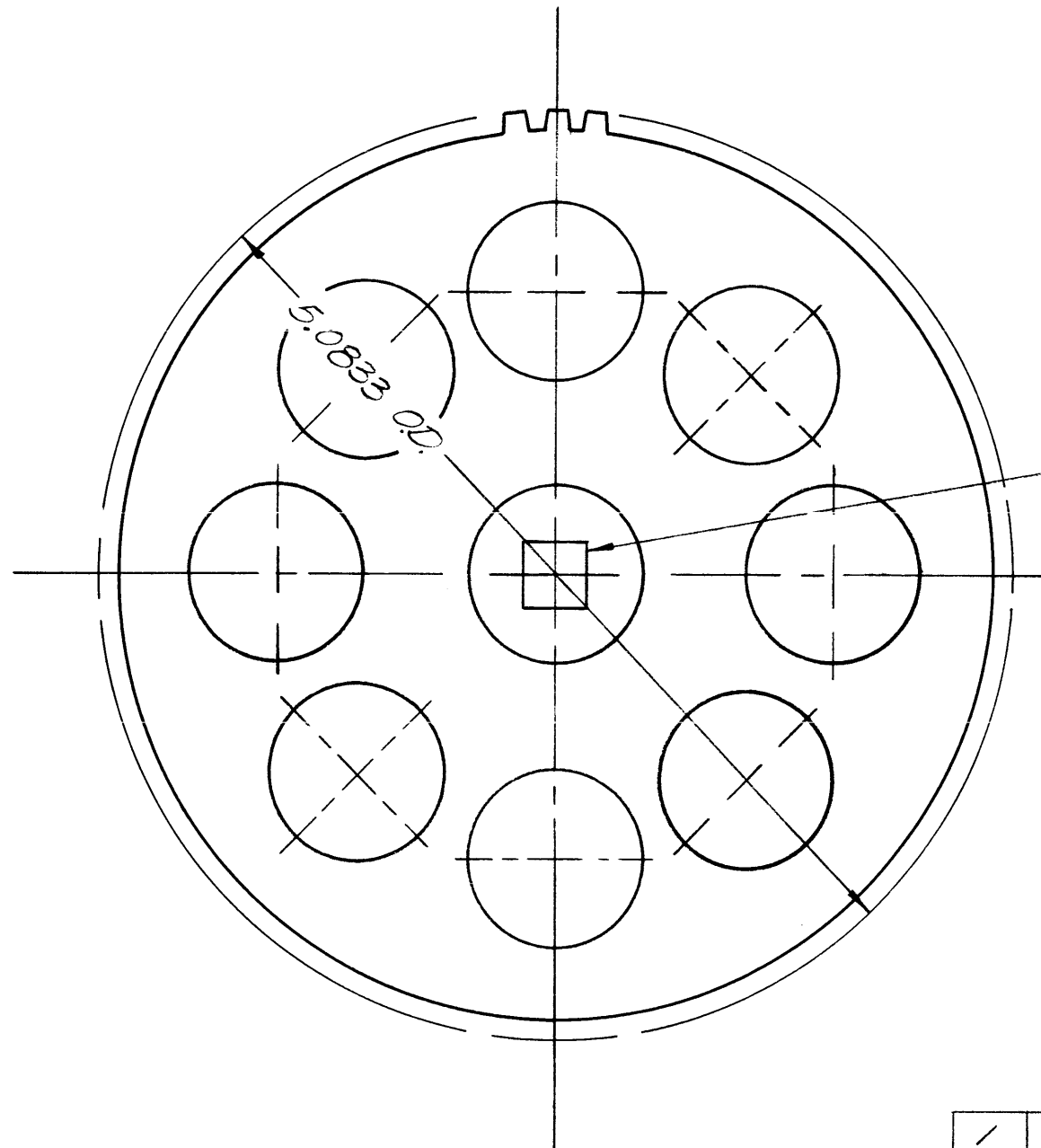
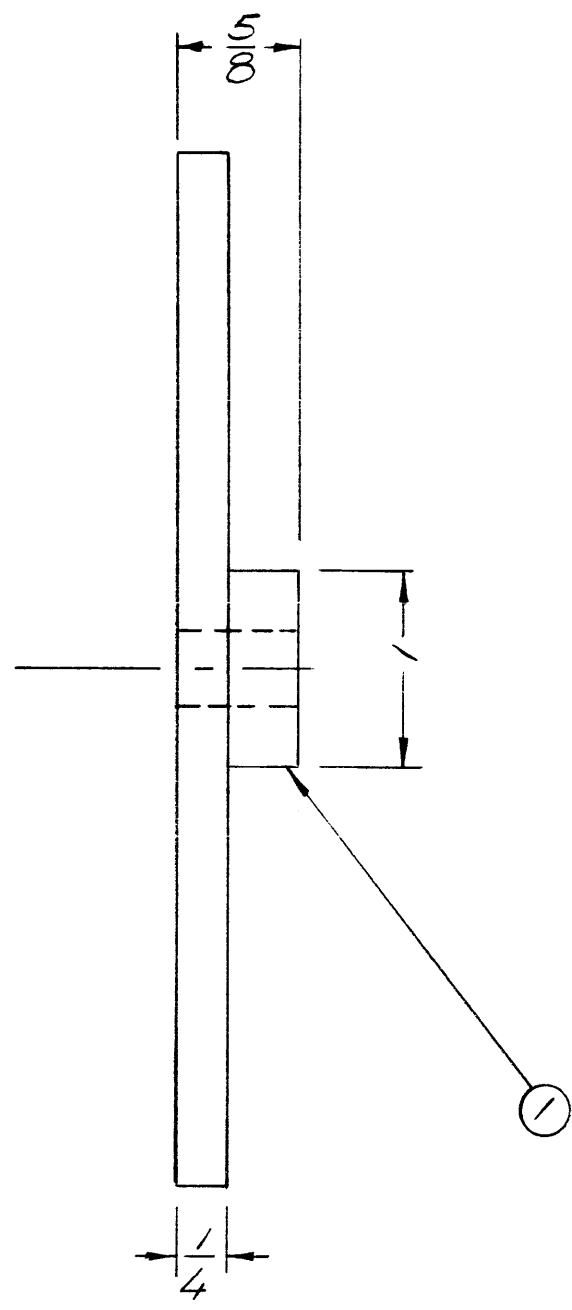

.375  $\pm$ .000 SQ. BROACH

SPECIFICATIONS

PITCH - 24  
 PRESSURE ANGLE 20°  
 TEETH 120  
 OUTSIDE DIAMETER 5.0833  
 PITCH DIAMETER 5.000  
 (TO BE MADE FROM GR 205-45)

REQ'D	ITEM	PART NUMBER	DESCRIPTION	SYM.
1	1	GR 205-45	GEAR SPUR HUB	

**F. BUDETTI** LIST OF MATERIAL

FINAL APPROVAL	DATE
<i>ALP</i>	12-70
MECH. DES.	DATE
<i>ALP</i>	1-12-70
ELECT. DES.	DATE
CHECKED	DATE
DRAWN	DATE
<i>EVANGELIS</i>	12/5/69

**THE TECHNICAL MATERIEL CORP.**  
 MAMARONECK, NEW YORK

**GEAR SPUR SPECIAL**

1	PALA-10K	AS145
QTY / UNIT	MODEL USED ON	ASS'Y NO.
APPLICATION		
CODE		

UNLESS OTHERWISE SPECIFIED DIMENSIONS ARE IN INCHES AND INCLUDE CHEMICALLY APPLIED OR PLATED FINISHES

DECIMALS	FRACTIONS
.X $\pm$ .05	1/64
.XX $\pm$ .01	TOLS. ANGLES
.XXX $\pm$ .005	0° - 30'

MATERIAL **BRASS**

FINISH

**NOTICE TO PERSONS RECEIVING THIS DRAWING**  
 THE TECHNICAL MATERIEL CORPORATION claims proprietary right in the material disclosed hereon. This drawing is issued in confidence for engineering information only and may not be reproduced or used to manufacture anything shown hereon without permission from THE TECHNICAL MATERIEL CORPORATION to the user. This drawing is loaned for mutual assistance and is subject to recall at any time.

SIZE	CODE IDENT. NO.	DWG NO.	ISSUE
B	82679	GR 237	Ø
SCALE	SHEET OF		