

REQ. PER. UNIT	USED ON	GR-157	A
MODEL	ASST. NO.	CHG-1	
	DATE	9-2-60	

PITCH 48
 PRESSURE \angle 14 1/2°
 NO. OF TEETH 36
 FACE .250
 BORE .252
 PITCH DIA. .750
 HUB PROJ. .187

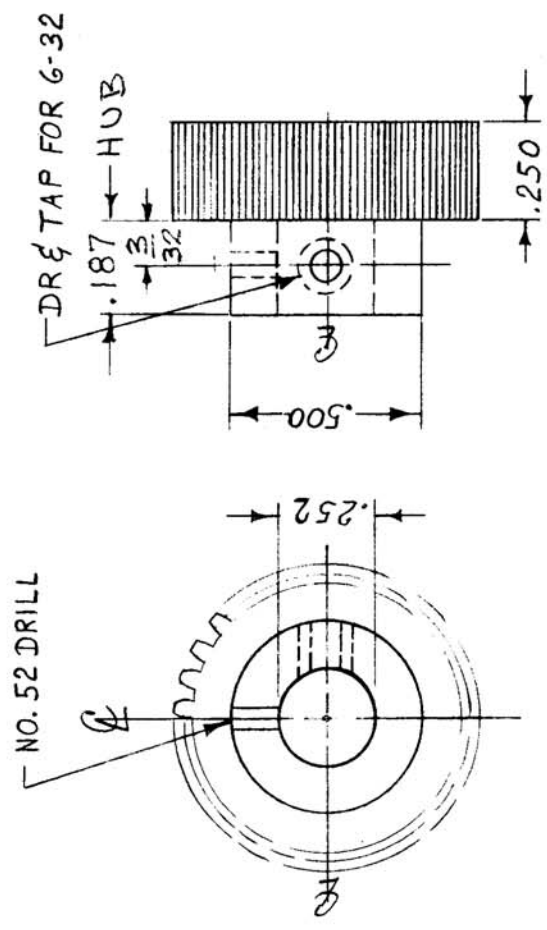

REG. ITEM	PART NO.	DESCRIPTION	SYMBOL
		THE TECHNICAL MATERIEL CORP. MAMARONECK, NEW YORK	
		GEAR, PINION	
		BRASS	
		MATERIAL	
		1/2 H	
		TYPE & TEMPER	
		HEATTREAT. SPEC.	
		FINISH & SPEC. NO.	
		ELEC. DES. APP. MECH. DES. APP.	
		CHECKER	
		DATE	
		CH. NO.	
		DRIFTS	
		RU	
		2-28-61	
		4285	
		CHANGED FROM	
		Dim .252 was .250	
		SCALE: 1:2	
		MAXIMUM ALLOWABLE TOLERANCES HAVE BEEN DETERMINED AND ANY DEVIATIONS WILL BE CAUSE FOR REJECTION. REMOVE ALL BURRS AND SHARP EDGES	
		TOLERANCES	
		DEC. DIM. \pm .0015	
		FRAC. DIM. \pm 1/64	
		ANGULAR DIM. \pm	
		DRAWN	
		CHECKED	
		FINAL APPROVAL	
		GR-157	A