

IF IT IS FOUND DESIRABLE TO CHANGE ANY TOLERANCE OR OTHER DETAIL SPECIFIED ON THIS DRAWING NOTIFY THE PURCHASER PROMPTLY.

MAXIMUM ALLOWABLE TOLERANCES HAVE BEEN DETERMINED AND DEVIATIONS WILL BE CAUSE FOR REJECTION. REMOVE ALL BURRS AND SHARP EDGES

TMC NO.	PART. NO.	A I.D.	B	PANEL HOLE SIZE	USE TOOL TYPE
FS-109-1	3	.172	.022	3/16	FRST 3
-2	3 1/2	.202	.022	7/32	3 1/2
-3	4	.230	.029	1/4	4
-4	5	.288	.035	5/16	5
-5	6	.345	.043	3/8	6
-6	7	.402	.051	7/16	7

MATERIAL - STEEL, HEAT TREATED, CADMIUM PLATED.

TOL. "A" 3-6 - 6%  
"B" 4-6 - 4%

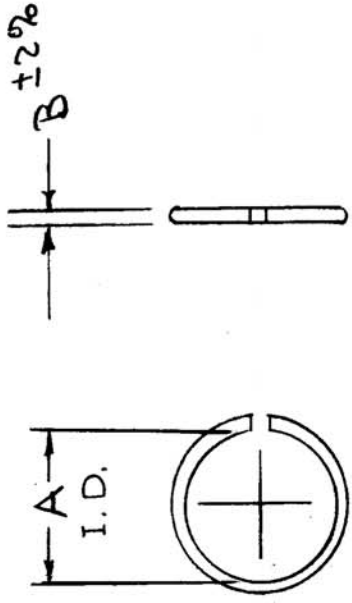

REF: DZUS MFG. CO.

FS-109

Req. Per UNIT 13  
 MODEL XFK  
 PROJECT NO. \_\_\_\_\_  
 ASSY. NO. \_\_\_\_\_  
 USED ON \_\_\_\_\_  
 DATE \_\_\_\_\_

REQ. ITEM # \_\_\_\_\_ PART NO. # \_\_\_\_\_ SYMBOL \_\_\_\_\_  
 DESCRIPTION THE TECHNICAL MATERIEL CORP. MAMARONECK, NEW YORK  
 STOCK SIZE # \_\_\_\_\_  
 MATERIAL # \_\_\_\_\_ WEIGHT PER PC. # \_\_\_\_\_  
 TYPE & TEMPER # \_\_\_\_\_  
 HEAT TREAT. SPEC. # \_\_\_\_\_  
 FINISH & SPEC. NO. # \_\_\_\_\_  
 DRAWN *WDC* CHECKED *WDC* FINAL APPROVAL *WDC*  
 ELEC. DES. APP. \_\_\_\_\_ MECH. DES. APP. \_\_\_\_\_  
 CDD B-24-SA

ISSUE ITEM A 1  
 CHANGED FROM \_\_\_\_\_  
 DATE 6-14-62  
 CN. NO. 6790  
 V.R.R. *WDC*  
 DRAFTS CHECKER *WDC*  
 SCALE \_\_\_\_\_  
 TOLERANCES  
 DEC. DIM. ±  
 FRAC. DIM. ±  
 ANGULAR DIM. ±  
 DRILL, PUNCH, COMMERCIAL STOCK SIZES AND MANUFACTURERS TOLERANCES ARE NOT INCLUDED.